



Operating manual

TURBO-STRIPPER 230 V/ 50 Hz

TURBO-STRIPPER 115 V/ 50-60 Hz

English

Item-No. 038587

Item-No. 039087

Read before use and keep safe



Contents

Technical data	Page 9
Safety	Page 9
Safety Instructions	Page 9
Maintenance	Page 11
Use	Page 11
Information about various floorings	Page 13
Trouble Shooting	Page 13
Spare Parts / drawing	appendix



1.0 Technical Data

Power supply	.115 V / 100 V
Power consumption	.2200 W / 1400 W
Number of strokes	.5000 strokes/min
Sound pressure level	.92 dB(A)
Sound energy level	.105 dB(A)
Hand/Arm-Vibration	.10 m/s ²
Weight	.150 kg

Comes with:

- Turbo-Stripper
- Spare blade
- Ear protectors
- Tools
- Additional weight
- Operating manual
- Safety gloves

2.0 CE Declaration of conformity

We declare under our sole responsibility that this product is in conformity with the following standards of standardization documents: EN 50 144, according to the provisions of the Directives 73/23/EWG, 89/336/EWG 98/37 EG

CE 05

Dipl.-Ing. (FH) Dieter Hammel
Konstruktionsleitung

i.v.

WOLFF | Eine Marke der Uzin Utz Gruppe | D-71665 Vaihingen/Enz | Dieselstraße 19

3.0 Safety instructions

Disconnect the power supply before any maintenance is carried out. Use only recommended blades and ensure it is sharp before starting.

Maintenance should be undertaken only by qualified personnel. Use only genuine Wolff spare parts.

Transport

To avoid harm or danger, always remove the blade before transporting the machine.

Disconnect the power supply and the plug (2) of the clutch before removing the handle. Otherwise you might damage the hydraulics of the clutch.

Mount the steel plate (1) instead of the clutch (2) and fasten it with thumb screw (4).

Turn thumb screw (3) clockwise until the transport wheels are blocked. Thus the machine cannot move by itself.

Never transport the machine without the wheels blocked.

Using this machine without ear protectors may jeopardize or harm your health. It may harm especially your ears and increase the risk of an accident.

The user and any person not far off should always use ear protectors!

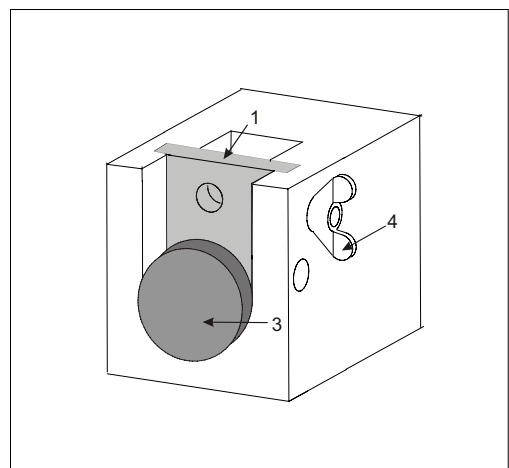

Always wear ear protectors!





3.1 Introduction

This operating manual should be used to get the most benefit from your Turbo-Stripper.

Following these instructions will both extend the life of your machine and reduce repair costs. Please ensure any user of the machine is fully familiar with the instructions for use before allowing work to start.



Use this machine only

- as instructed in this operating manual
- with the machine in perfect working order.



Wolff cannot be held responsible for any damage or loss caused by incorrect use. Correct use also includes

- to take care of all directions from the operating manual and
- the execution of maintenance and service.

3.2 Danger while working with the machine

The Turbo-Stripper is designed to the highest technical standards. Incorrect use can be dangerous!

Disturbances that could impair safety, have to be eliminated at once.

3.3 Restriction of use

The Turbo-Stripper is exclusively for removing bonded floor coverings in dry environments.

It should not be used for any other purpose. Wolff cannot be held responsible for any damage or loss caused by incorrect use.

3.4 Genuine Spare Parts

Spare parts and accessories are manufactured uniquely for the Turbo-Stripper. It must be emphasized that parts obtained from unauthorized sources must not be used.

Wolff cannot be held responsible for the performance of or any damage arising from the use of machines in which genuine spare parts have not been used.

This is particularly important with replacement blades.

3.5 Low-voltage protection

The Turbo-Stripper is equipped with a low-voltage protection switch. The power supply breaks if current fluctuation or mains power failures occur, thus preventing serious perilous accidents.

Due to the restart protection, the machine will not restart after a power failure, even if the operation switch has not been switched off.

For using the protective cut-out switch see also item 5.0 Application



4.0 Maintenance

The Turbo-Stripper is virtually maintenance-free. Have the guides of the swing bolts lubricated from time to time (after approx. 500 square meters).

The lubricator nipples are located collateral on the front side (see picture). The used grease will flush dirt out of the machine.

Press maximum 3 to 4 times with the grease gun. Never press too much grease into the machine. Otherwise the mechanism will be blocked.

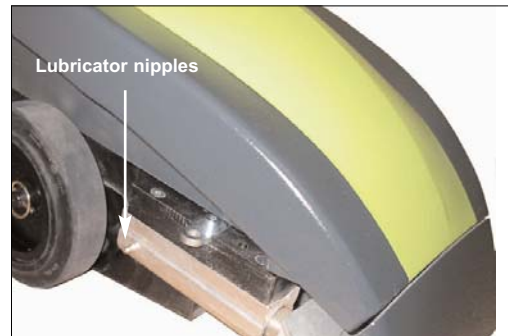

Changing the blade

Disconnect the power supply before changing the blade. Use work gloves for your own safety.

- tip the machine
- put on the blade protection (enclosed in the tools set)
Warning! Very sharp blade! You may cause injury without using the blade protection!
- secure the tipped machine from tilting over
- clean and loosen the screws of the blade mounting,
Attention! Set the wrench at a position opposite to the blade to avoid injury.
- replace the blade.

Make sure that the blade fits in exactly into the support. On normal and hard subfloors the bevel of the blade should show upwards (1), on soft subfloors (e.g. chipboards) the bevel should show downwards (2).

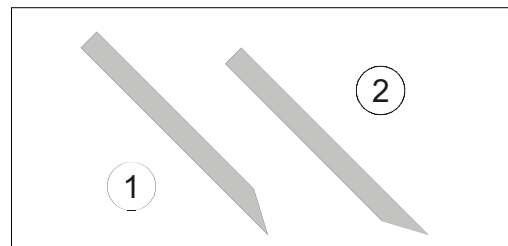

Changing the driving wheels

Remove the splint-pins and pull the wheels from the axle. Do not loose the springs under any circumstances!

5.0 Use

The Turbo-Stripper removes any bonded floor coverings in strips. This procedure corresponds with the customary method of using a hand floor scraper. The stripper works with a thin steel blade at very high frequency, minimizing vibration and noise.

The Turbo-Stripper is self propelled. The motor actuates both the blade and the machine movement. The blade drive starts as soon as the machine is switched on. The hand clutch will engage the drive.

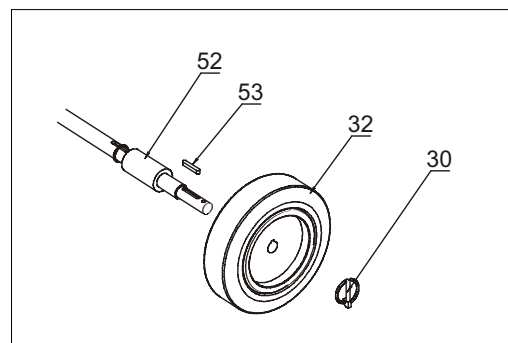

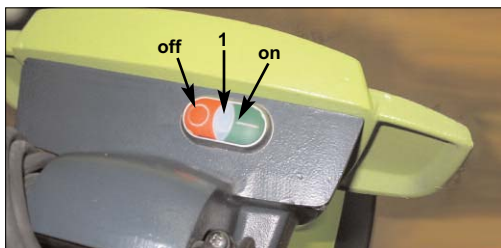

Starting

The Turbo-Stripper is equipped with a power-on indicator lamp (1) and an operating switch located at the top of the handle. The switch has a restart protection for low-voltage failures.

If the lamp does not indicate power-on, use another power socket or check power supply.

If a mains power failure occurs during operation, switch-on the machine again.

Before starting work, cut the floor covering into strips of about 35 cm (12 inch). You cannot work faster if you cut wider strips.

To begin, cut one strip crosswise.

Then lift the floor slightly in order to get the blade underneath it.

We recommend to cut the first strip at right angles to the main working direction. By so doing access to the adjacent strips is made easier.

Cut the strips smaller if the floor covering is bonded very securely, e.g. with an epoxy adhesive.

The blades are sharpened by the floor pavement. Therefore the blade only has to be changed if it is twisted, collateral rounded or becomes worn.

The driving wheels are subjected to wear. They have to be changed after approximately 16 mm (0.6 inch) of the surface has been worn away. Otherwise the working angle of the striking apparatus will not be correct especially critical with cork or foam backed carpets.

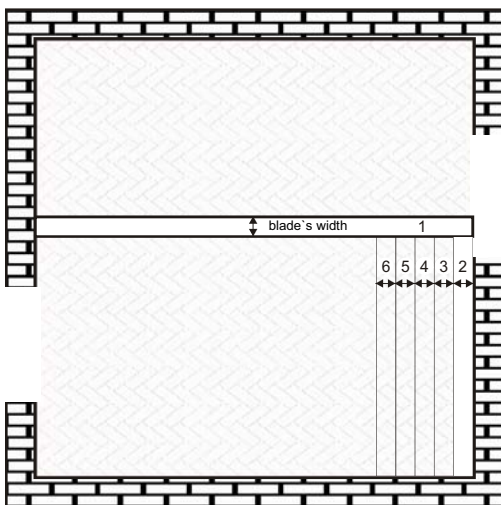

If the machine is switched on, but the hand clutch is not engaged, it might happen that the machine runs slowly "backwards". This is caused by the return stroke of the blade action. It means no failure of the Turbo-Stripper.

Assembly of support for additional weight (accessory)

Item no. 038535

The weight of the Turbo-Stripper is expandable by 1 up to 3 additional weights (1 single weight = 30 kg).

Individual weight shifting is possible at 3 positions (see picture)."



pos. ahead pos. center pos. backward

without additional weight with 3 additional weights





Emergency running

The Turbo-Stripper can be operated also with broken or damaged hand clutch as follows:

- ❑ disconnect power supply
- ❑ remove emergency-run-plate (1) (mounted on top of the plug of the hand clutch (2))
- ❑ insert emergency-run-plate instead of the plug
- ❑ screw-in thumb-screw (3) until the driving wheels are blocked
- ❑ fix emergency-run-plate with thumb-screw (4)
- ❑ If the emergency-run-plate is mounted, the motor drive is always switched on. The machine starts running immediately after switching on.

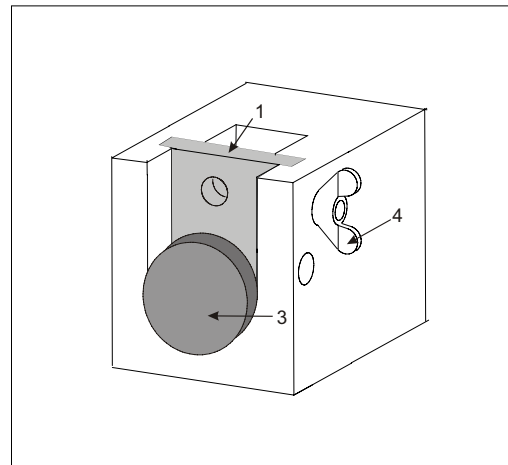

English

6.0 Information about certain floor coverings

Needlepunch felt and tufted carpets on jute hessian backings

Cut into strips of approx. 35 cm (14inch) width. If the flooring is bonded very tight, cut strips smaller. The machine should remove the flooring without slipping wheels.

Carpets with foam backing

A sharp blade is essential in order to ensure the floor covering is removed together with the foam backing.

Remove floorings across the width, particularly if you have an uneven sub-floor.

Tiles

Use blade of the same width as the tiles and use a new blade. Tiles above size 30 x 30cm (12 x 12inch) have to be cut into half. If the sub-floor is uneven, use smaller blades.

In all cases, check from time to time to ensure the blade is still sharp. If it is not or any distortion has occurred, replace it immediately.

7.0 Trouble Shooting

Trouble	Eventual cause	Elimination
Machine does not run	Power supply disconnected blown fuse defective cable or plug	Have machine repaired by a qualified electrician, respective change parts
Undue force necessary or excessive vibration	Blade is blunt	Change blade
Excessive vibration	Expendable parts are worn out	Return machine for service and/or repair