

3. Description

Operate the machine only using tools in accordance with the manufacturer's instruction. Using other tools is considered contrary to its designated use. The manufacturer cannot be held liable for any damage resulting from such use. The risk of such misuse lies entirely with the user.

3.1 Main parts

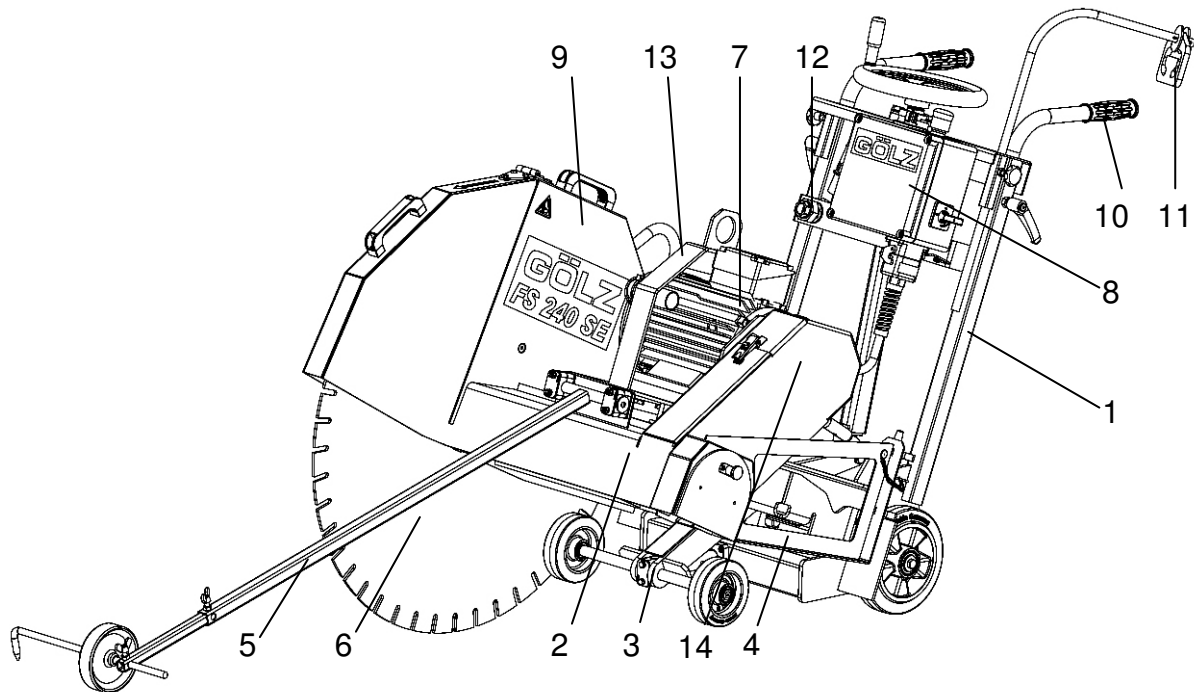

1. Control panel
2. Chassis
3. Undercarriage
4. Flange guard
5. Pointer unit
6. Blade

7. Electric motor
8. Switch box with
electrical connection
9. Blade guard
10. Connecting rod
11. Strain relief

12. Water connection
13. Eyebolt and
Engine bracket
14. Blade guard pulley

3.2 Technical data

Max. cutting depth	330 mm - 13 in.
Max. blade-Ø	800 mm - 31,5 in.
Flange size	Ø 120 mm - 4,7 in.
Blade shaft size	Ø 25,4 mm - 1 in.
Engine	3-phases-motor 7,5kW (10 HP), 14,4 A

Max. cutting speed with blade	60 m/s
Engine shaft speed	2860 rpm
Blade shaft speed	1430 rpm
Feed	Manual
Excavation	Manual (hand crank)
Cutting depth control	Scale on frame
Water supply	Connection for external water supply
V-belt tension	Manual
Dimensions (L x W x H)	approx. 1650 x 733 x 989 mm - 65 x 28,9 x 178,7 in.
Weight (without water tank and blade)	ca. 187 kg - 415,5 lbs.
Sound power level after DIN ISO 6393	No load = 100 dB(A) Full load = 119 dB(A)
Sound pressure level after DIN ISO 6393	No load = 80 dB(A) Full load = 100 dB(A)
Vibration after ISO 5349 VDMA 03/2006	a = 3,7 m/s ²

3.3 Safety devices



Danger: During cutting or displacing the machine, all safety devices shown below must be mounted!

